

# 18107

## 90 DEGREE ATTACHMENT ONLY ALL BEARING 90° JMD ATTACHMENT

	A	B	C	D	E
INCH	.45	1.17	.90	3.40	.93
MM	11.4	29.7	22.8	86.4	23.6

MAXIMUM RECOMMENDED DRILL DIAMETER = .375 INCH / 9.5 MM

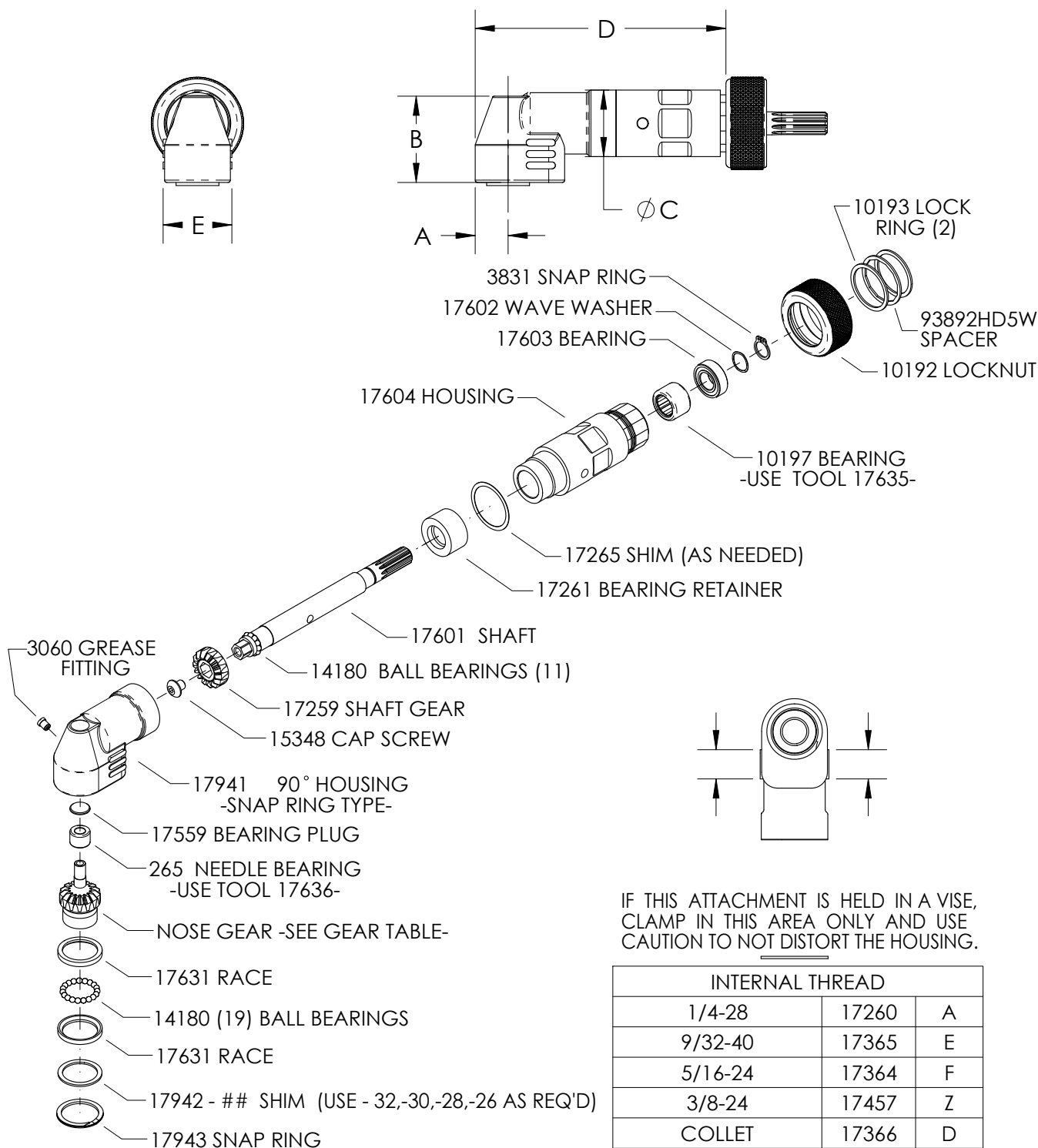

INTERNAL THREAD		
1/4-28	17260	A
9/32-40	17365	E
5/16-24	17364	F
3/8-24	17457	Z
COLLET	17366	D
3/8-24 EXTERNAL	17345	Y