

	A	B	C	D	90 DEGREE DRILL	
INCH	.312	.937	.625	3.550	MAXIMUM RECOMMENDED DRILL DIAMETER	.250
MM	7.92	23.7	15.87	90.17		6.35 mm

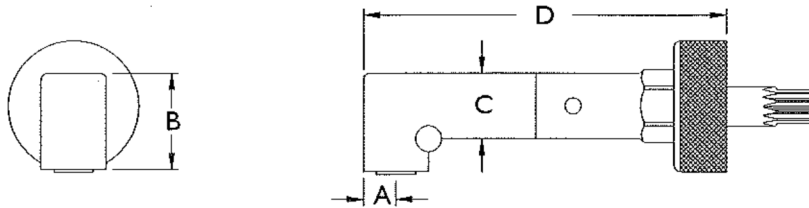

## BUSHING TYPE 90 DEGREE DRILLS



## 17169 ATTACHMENT ONLY

### PART OF THE JIFFY MODULAR DRILL SYSTEM

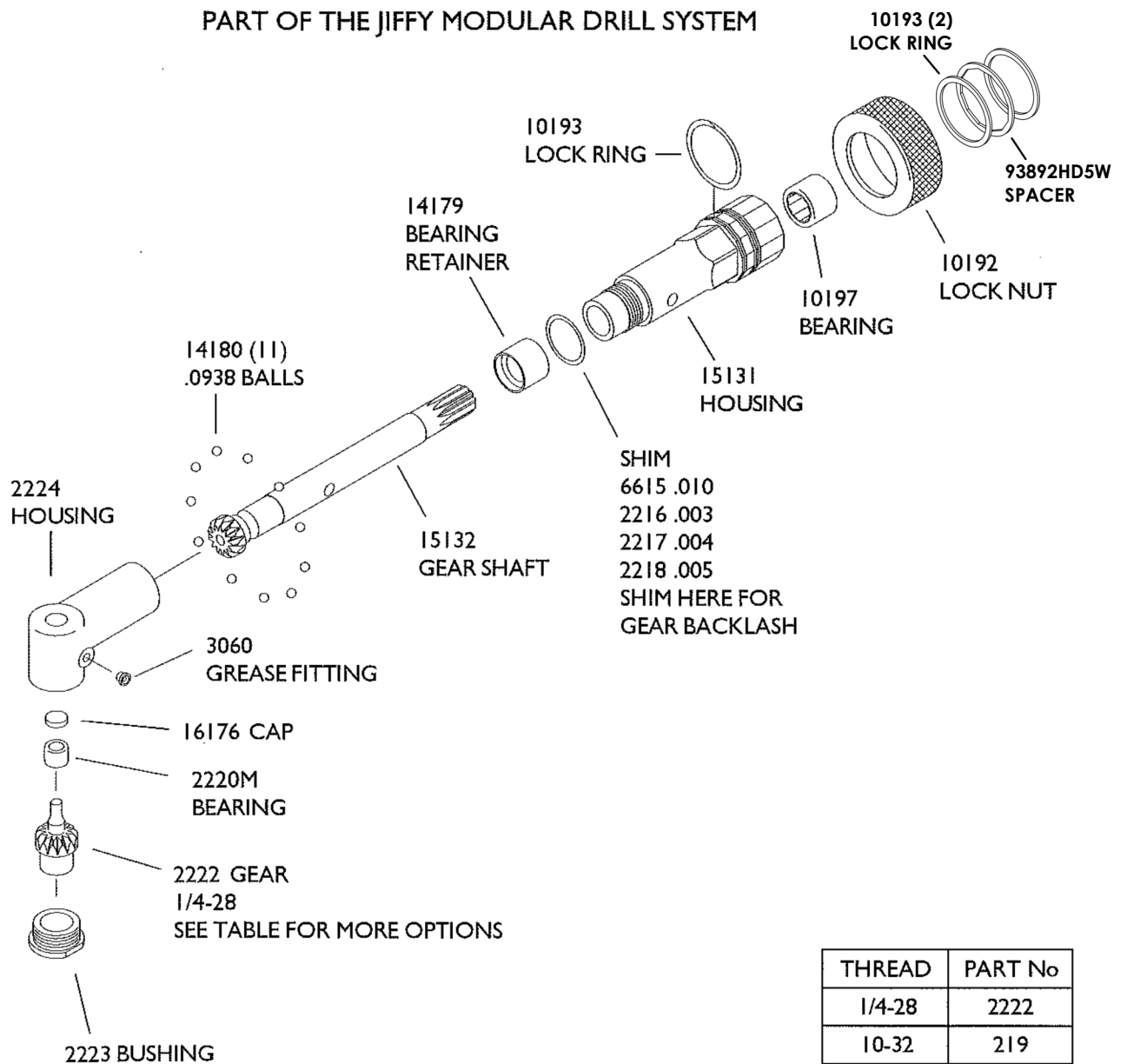

THREAD	PART No
1/4-28	2222
10-32	219
9/32-40	2221
5/16-24	6336